

MULTI-LINGUISTIC SPEECH-TO-TEXT TRANSCRIBER

TECHNOLOGY OVERVIEW

Existing assistive devices for hearing impairment focus on sign language interpretation via video relay service. However, current technology still lacks the ability for spoken words to be transcribed accurately into readable texts in real-time. This Speech-to-Text Transcriber software developed by RP is a low-cost assistive tool that facilitates a hearing impaired person to communicate more effectively in public.



The application supports multi-language transcribing on mobile and wearable devices such as smart phones, tablets and laptops. While the transcribing software runs faster and more accurate than other existing technologies, it is able to tolerate different accents and a certain level of surrounding noise. Not only is the transcriber software able to support many-to-one communication in open space or indoor environment, it can also recognise common languages that are spoken in our multi-ethnic and multi-cultural society.

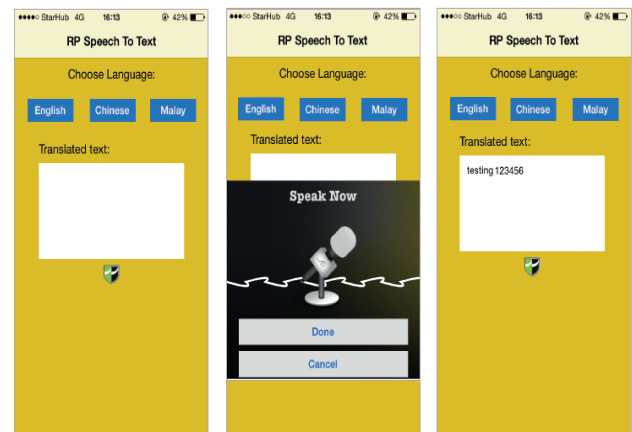

POTENTIAL APPLICATIONS

This software leverages on the mobile/wearable computing devices to provide a more effective real-time transcribing tool for the deaf and the elderly to interpret spoken words.

MARKET OPPORTUNITIES

The software can be adapted to meet various market opportunities, ranging from hospitals, elder care services, radio and live TV broadcasts, recording meeting minutes and notes taking, journalism, forensic investigations, air traffic control, and real time language translator for travelers.

COMMERCIALISATION

This software is available for licensing.

Looking for an open innovation partner? Contact Republic Polytechnic today!

Whether you are looking for new ideas to improve your current business flow, need access to research and technology expertise, or require facilities to bring your innovative ideas to life, we may be the partner for you.

At Republic Polytechnic (RP), we bridge the gap between knowledge and application by facilitating information and technology transfer to industry partners. Taking a holistic approach, our team of experts can assess your business needs, provide consultancy, conduct feasibility studies, and render support to help increase your company's competitiveness.

Facilities and Equipment

RP is home to state-of-the-art facilities and the latest technology, which are on par with industry standards. You can access these facilities by collaborating with RP on joint projects or through facility and equipment rentals.

Research and Development

Transform your ideas into reality. RP's multidisciplinary applied R&D centres can work with you in many different ways, including exploiting new technologies, developing new products and streamlining processes.

Current Opportunities for Collaboration and Commercialisation

- Innovative Single-tube Multiplex Diagnostic Platform for Dengue and Chikungunya Viruses
- New Chemical Entities with Potential Applications in Photodynamic Therapy
- Wireless Proximity Sensing for Safety and Security Applications
- Cloud-based Logistics Tracking
- Multilingual Note Taking Software with Speaker Recognition
- Ambidexter: Portable Rehabilitation Device for Training Fine Motor Skills
- Plastic Heat Sink: Prevents heat related failures in integrated circuits and devices
- E-Scooter- Wheelchair Dockable

For more details, visit <http://www.rp.edu.sg/Industry.aspx>, or email us at help-otd@rp.edu.sg.